

# VALUE SHOPPER GENERATION 3 #440300 (EXPLODED VIEW)

FEBRUARY 2009 – AUGUST 2009

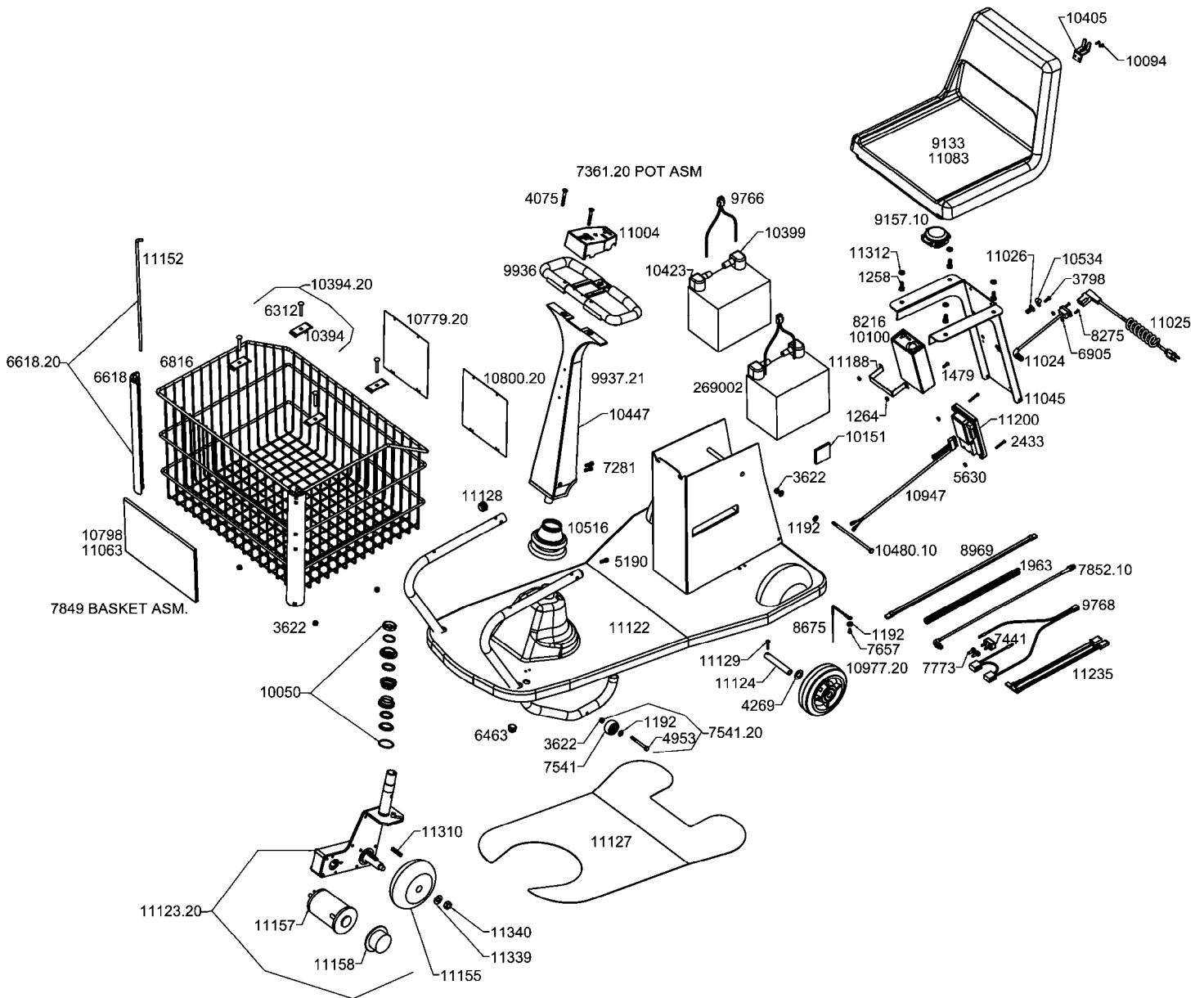

## AMIGO MOBILITY INTERNATIONAL, INC.

6693 Dixie Highway • Bridgeport, MI 48722-9725

Phone: (800) 248-9131 • Fax: (800) 334-7274 • [www.myamigo.com](http://www.myamigo.com)

**VALUE SHOPPER GENERATION 3 #440300 PARTS LIST – FEBRUARY 2009 – AUGUST 2009**

<u>Part #</u>	<u>Description</u>	<u>Qty/unit</u>	<u>Part #</u>	<u>Description</u>	<u>Qty/unit</u>
1192	Washer, Flat, .281 ID .625 OD .06	5	10423	Boot, Battery Terminal, Black	2
1258	Screw, Hex Head, 5/16-18 X .75	4	10447	Handle Back Plate	1
1264	Nut, Keps, #10-32	2	10480.10	Screw, Hex Head, 1/4-20 x 6.5 Lg	1
1479	Screw, Phillips, #10-32 X .63 Lg	2	10516	Boot, Lower Handle	1
1963	Loom, Wire	42	10534	Clamp, Nylon Cable	1
2433	Screw, Phillips, #8-32 X 1.25	2	10798	Sign, "For Our Valued Customers"	1
3622	Nut, Hex Head, Nylon Insert, 1/4-20	7	10799.20	Sign, Operating Instructions, English/Spanish	1
3798	Screw, Phillips, #10-24 X .63	1	10800.20	Sign, Safety, English/Spanish	1
4075	Screw, Flat Head Cap, 1/4-20 X 2.0 Lg	2	10947	Wire Asm Interface, Controller	1
4269	Washer, 5/8" ID, 1 1/8" OD	2	10977.20	Wheel Asm, 6" Rear	2
4953	Screw, Hex Head, 1/4-20 X 2.5 LG	2	11004	Enclosure Asm w/ Rocker Switch	1
5190	Screw, Socket Head Cap, 1/4-28 X .75 Lg	1	11004.24	Enclosure Asm w/ Rocker Switch & ETI Pot	1
5630	Nut, Keps, #8-32	2	11024	AC Receptacle	1
6312	Screw, Carriage, 1/4-20 X 1.75	4	11025	Power Cord, AC Retractable	1
6463	Plug, Round, 7/8" Diameter	1	11026	Jacknut, #10-24	1
6618	Bbumper, Vertical	2	11045	Pedestal Cover	1
6618.20	Bumper, Asm	2	11063	Sign "For Our Valued Members"	1
6816	Basket, Shopper	1	11083	Seat, Heavy Duty, PVC Free	1
6905	Nut, Keps, #6-32	2	11122	Platform, Black	1
7281	Screw, Socket Head Cap, 1/4-20 X .88 Lg	2	11123.20	Drive Asm, Front w/ Brake	1
7361.20	Potentiometer Asm	1	11124	Axle, Short	2
7441	Circuit Breaker, Auto Reset, 25 Amp	1	11127	Mat, Standard	1
7541	Wheel, Stability, 1.6"	2	11128	Plug, Round, 1" Diameter	2
7541.20	Wheel Asm, Stability	2	11129	Screw, Phillips, #10-32 x 1 Lg	2
7657	Screw, Phillips #10-32 X .38 Lg	1	11130	Label, Pedestal, Blue	1
7773	Cap, Vinyl Insulated	2	11133	Label, Pedestal, Red	1
7849	Basket Asm, Value Shopper	1	11152	Rod, Basket Bumper	2
7852.10	Wire Asm., Charger To Controller (11200)	1	11155	Wheel Asm, Front Gear Drive	1
8216	Charger, Standard, 3 Amp	1	11157	Motor, Front Gear Drive	1
8275	Screw, Phillips Flat Head, #6-32 X .5 Lg	2	11158	Brake Asm, Front Gear Drive	1
8675	Ground Wire Asm	1	11166	Label, Front, Blue	1
8969	Cable, MPC Handle Control	1	11167	Label, Front, Red	1
9133	Seat, Shopper	1	11188	Strap, 7 Amp Charger	1
9157.10	Switch, Seat	1	11200WG3	Controller CS1108S (Wegmens)	1
9766	Wire Asm, Battery To Quick Connect	2	11200VS3	Controller CS1108S Standard	1
9768	Wire Asm, Battery Quick Connect To Controller	1	11235	Wire Harness Asm, Front Gear Drive	1
9936	Handle, Upper	1	11242	Label, Pedestal, Light Green	1
9937.21	Column Asm Non-Tilt Handle	1	11243	Label, Front, Light Green	1
10050	Bearing Set	1	11248	Label, Pedestal, Light Blue	1
10094	Screw, Self Tapping, #8-32 X .38 Lg	2	11310	Key, Axle	1
10100	Charger, 7 Amp	1	11312	Washer, Lock, 5/16 OD	4
10151	Foam Insert, Adhesive Backed	5	11339	Washer, .53 ID, 1.06 OD	1
10394	Strap Basket Support	4	11340	Nut, Lock, 1/2-20	1
10399	Boot, Battery Terminal, Red	2	269002	Battery, 12 Volt, 33 AH (U-1)	2
10405	Bracket, Power Cord Holder	1			

January 2010



**AMIGO MOBILITY INTERNATIONAL, INC.**

6693 Dixie Highway • Bridgeport, MI 48722-9725

Phone: (800) 248-9131 • Fax: (800) 334-7274 • www.myamigo.com